

# Spherical Plain Bearings Series G - Maintenance Free

## Series GE...FW (-2RS)

Spherical Plain Bearings series G to DIN ISO 12240-1. Mating surface hard chromium/PTFE, maintenance free

Higher pivoting angle through wider ball

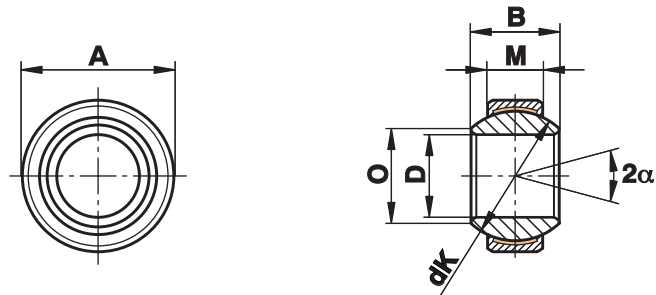

Size (D)	B	M	A	O	dK	Static load C <sub>0</sub> kN	Static load C <sub>0</sub> kN -2RS	Dynamic load C kN	Dynamic load C kN -2RS	Pivoting angle α	Weight g
4 <sup>0</sup> <sub>-0,008</sub>	4	4	14 <sup>0</sup> <sub>-0,008</sub>	7,1	10,0	9,1	-	3,6	-	20	5
5 <sup>0</sup> <sub>-0,008</sub>	5	5	16 <sup>0</sup> <sub>-0,008</sub>	9,3	13,0	14,0	-	5,8	-	21	8
6 <sup>0</sup> <sub>-0,008</sub>	9	5	16 <sup>0</sup> <sub>-0,008</sub>	9,3	13,0	14,0	-	5,8	-	21	9
8 <sup>0</sup> <sub>-0,008</sub>	11	6	19 <sup>0</sup> <sub>-0,009</sub>	11,6	16,0	21,0	-	8,6	-	21	14
10 <sup>0</sup> <sub>-0,008</sub>	12	7	22 <sup>0</sup> <sub>-0,009</sub>	13,4	18,0	28,0	-	11,0	-	18	21
12 <sup>0</sup> <sub>-0,008</sub>	15	9	26 <sup>0</sup> <sub>-0,009</sub>	16,0	22,0	45,0	-	18,0	-	18	33
15 <sup>0</sup> <sub>-0,008</sub>	16	10	30 <sup>0</sup> <sub>-0,009</sub>	19,2	25,0	56,0	75,0	22,0	32,0	16	49
17 <sup>0</sup> <sub>-0,008</sub>	20	12	35 <sup>0</sup> <sub>-0,011</sub>	21,0	29,0	78,0	104,0	31,0	45,0	19	83
20 <sup>0</sup> <sub>-0,010</sub>	25	16	42 <sup>0</sup> <sub>-0,011</sub>	25,2	35,5	127,0	204,0	51,0	85,0	17	153
25 <sup>0</sup> <sub>-0,010</sub>	28	18	47 <sup>0</sup> <sub>-0,011</sub>	29,5	40,7	166,0	263,0	65,0	110,0	17	203
30 <sup>0</sup> <sub>-0,010</sub>	32	20	55 <sup>0</sup> <sub>-0,013</sub>	34,4	47,0	211,0	338,0	84,0	140,0	17	304
35 <sup>0</sup> <sub>-0,012</sub>	35	22	62 <sup>0</sup> <sub>-0,013</sub>	39,7	53,0	262,0	419,0	104,0	175,0	16	408
40 <sup>0</sup> <sub>-0,012</sub>	40	25	68 <sup>0</sup> <sub>-0,013</sub>	44,7	60,0	337,0	540,0	135,0	225,0	17	542
45 <sup>0</sup> <sub>-0,012</sub>	43	28	75 <sup>0</sup> <sub>-0,013</sub>	50,0	66,0	415,0	665,0	166,0	275,0	15	713
50 <sup>0</sup> <sub>-0,012</sub>	56	36	90 <sup>0</sup> <sub>-0,013</sub>	57,1	80,0	-	1030,0	-	430,0	17	1420
60 <sup>0</sup> <sub>-0,015</sub>	63	40	105 <sup>0</sup> <sub>-0,015</sub>	67,0	92,0	-	1320,0	-	550,0	17	2090
70 <sup>0</sup> <sub>-0,015</sub>	70	45	120 <sup>0</sup> <sub>-0,015</sub>	78,2	105,0	-	1700,0	-	705,0	16	3010
80 <sup>0</sup> <sub>-0,015</sub>	75	50	130 <sup>0</sup> <sub>-0,015</sub>	87,1	115,0	-	2070,0	-	860,0	14	3610
90 <sup>0</sup> <sub>-0,020</sub>	85	55	150 <sup>0</sup> <sub>-0,018</sub>	98,3	130,0	-	2570,0	-	1070,0	15	5500
100 <sup>0</sup> <sub>-0,020</sub>	85	55	160 <sup>0</sup> <sub>-0,018</sub>	111,2	140,0	-	2770,0	-	1150,0	14	6040
110 <sup>0</sup> <sub>-0,020</sub>	100	70	180 <sup>0</sup> <sub>-0,025</sub>	124,8	160,0	-	4030,0	-	1680,0	12	9740
120 <sup>0</sup> <sub>-0,020</sub>	115	70	210 <sup>0</sup> <sub>-0,025</sub>	138,4	180,0	-	4530,0	-	1890,0	16	15100
140 <sup>1)</sup> <sub>-0,025</sub>	130	80	230 <sup>0</sup> <sub>-0,030</sub>	151,9	200,0	-	5760,0	-	2400,0	16	18900
160 <sup>1)</sup> <sub>-0,025</sub>	135	80	260 <sup>0</sup> <sub>-0,030</sub>	180,0	225,0	-	6480,0	-	2700,0	16	24800
180 <sup>1)</sup> <sub>-0,025</sub>	155	100	290 <sup>0</sup> <sub>-0,035</sub>	196,1	250,0	-	9000,0	-	3750,0	14	35900
200 <sup>1)</sup> <sub>-0,030</sub>	165	100	320 <sup>0</sup> <sub>-0,035</sub>	220,0	275,0	-	9900,0	-	4120,0	15	44900
220 <sup>1)</sup> <sub>-0,030</sub>	175	100	340 <sup>0</sup> <sub>-0,040</sub>	243,6	300,0	-	10800,0	-	4500,0	16	50900
240 <sup>1)</sup> <sub>-0,030</sub>	190	110	370 <sup>0</sup> <sub>-0,040</sub>	263,6	325,0	-	12870,0	-	5360,0	15	65300
260 <sup>1)</sup> <sub>-0,035</sub>	205	120	400 <sup>0</sup> <sub>-0,040</sub>	283,6	350,0	-	15120,0	-	6300,0	15	82000
280 <sup>1)</sup> <sub>-0,035</sub>	210	120	430 <sup>0</sup> <sub>-0,045</sub>	310,6	375,0	-	16200,0	-	6750,0	15	96600

### Materials:

**Insert:** Bearing steel with PTFE liner bonded to the inner surface  
 from size 15 available sealed (-2RS) on both sides  
 from size 50 only available sealed (-2RS) on both sides

**Ball:** Bearing steel to 100Cr6, Aisi 52100, hardened, ground, polished, hard chrome plated

<sup>1)</sup> from size 140 the hardened inserts are two pieced and secured with tension spring

On request available in stainless steel.

**FLURO-Gelenklager GmbH**