

Type:[Thrust Spherical Plain Bearings]

nd bore diameter range: GX...S 10-200

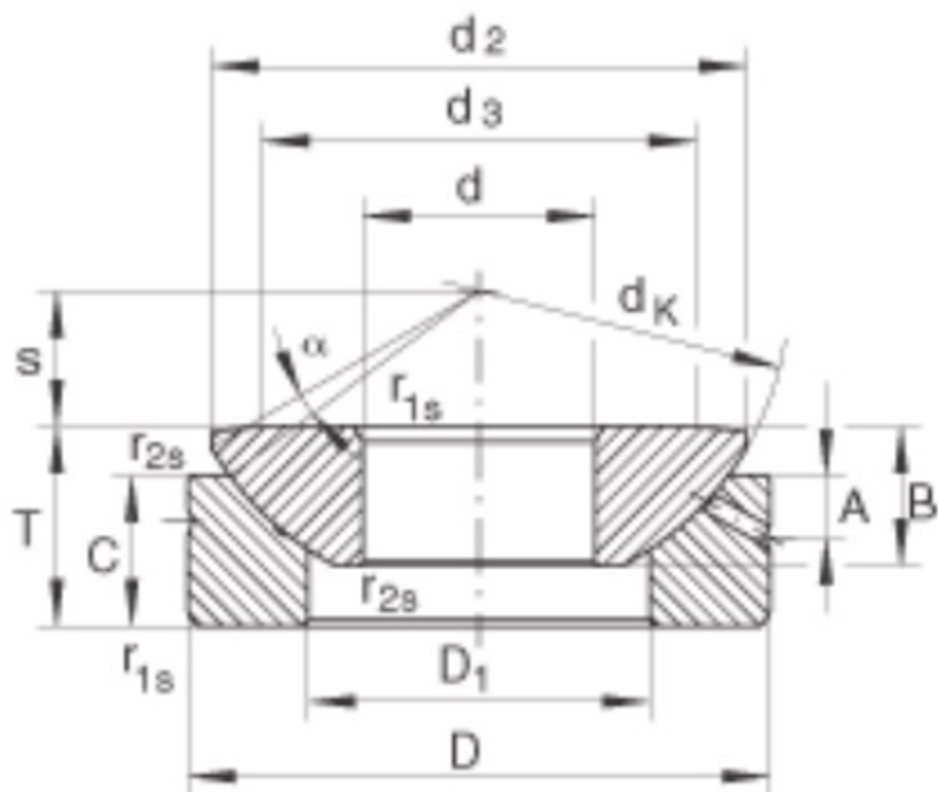

Design characteristics : Bearing housing washer of carbon chromium steel, hardened and phosphated, have groove and lubrication holes. Shaft washer of carbon chromium steel, hardened and phosphated. Sliding surfaces treated with MoS₂.

Sliding contact surfaces: Steel/Steel

Permissible operating temperature range: $-50^{\circ}\text{C} \sim +150^{\circ}\text{C}$

轴承 型号 Bearing number	外形尺寸 Dimensions mm											额定载荷 Load ratings kN		重量 Weight ≈kg
	d	D	B	C	H	d _k	S	d ₁ max	D ₁ min	r _s ,r _{1s} min	α° ≈	动载荷 Dynamic	静载荷 Static	
GX17N	17	47	11.8	11.2	16	52	11	43.5	27	0.6	4	32	52	0.137
GX20N	20	55	14.5	13.8	20	60	12.5	50	31	1	5	44	71	0.246
GX25N	25	62	16.5	16.7	22.5	68	14	58.5	34.5	1	5	65	104	0.415
GX30N	30	75	19	19	26	82	17.5	70	42	1	5	88	141	0.614
GX35N	35	90	22	20.7	28	98	22	84	50.5	1	5	129	207	0.973
GX40N	40	105	27	21.5	32	114	24.5	97	59	1	6	169	270	1.59
GX45N	45	120	31	25.5	36.5	128	27.5	110	67	1	6	230	368	2.24
GX50N	50	130	33	30.5	42.5	139	30	120	70	1	6	262	420	3.14
GX60N	60	150	37	34	45	160	35	140	84	1	6	374	599	4.63
GX70N	70	160	42	36.5	50	176	35	153	94.5	1	3	451	722	5.37
GX80N	80	180	43.5	38	50	197	42.5	172	107.5	1	4	558	893	6.91
GX100N	100	210	51	46	59	222	45	198	127	1.1	4	717	1140	11
GX120N	120	230	53.5	50	64	250	52.5	220	145	1.1	3	839	1340	14